

Two-position Sidewall Switch

Load Break Switch

Description

This switch was designed by JUDA electrical research institute. The switch adopts new structure, new material, new technology, having the advantages of reasonable structure good hand-feeling, Flexible rotary, reach the position accurately etc. It is the improved products of the off-circuit tap changer in china at present, which applies to single-phase, three phase, combination oil-immersed transformer electrical power with frequency of 50~60Hz, rated voltage of 10-35kV, rated current of 60-125A.



TS15-1P



TS35-1P



TS15-3P



TS35-3P

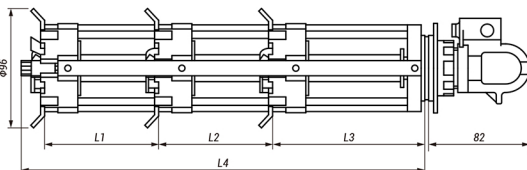
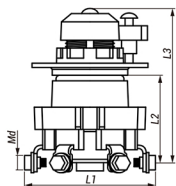

Specifications

Product Code	Voltage Ur (kV)	Current Ir (A)	Phase	Position
TS15-1P	15	63	1	6
TS35-1P	35	63	1	6
TS15-3P	15	63	3	6
TS35-3P	35	63	3	6

Dimension

Product Code	Regulating Position	Install Dimension (mm)				Holes on Tank Cover (mm)
		L1	L2	L3	L4/Md	
TS15-1P	Central	90	62	105	M6	φ33.5
TS35-1P		90	87	135	M8	
TS15-3P		60	60	50	190	
TS35-3P		90	90	125	322	