

# 24 kV - 630 A

## RMU bushings

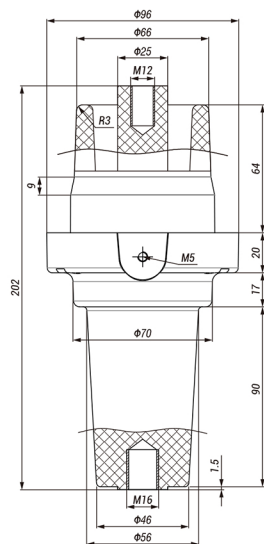

### Electrical Ratings

Maximum system voltage(Um): 24kV

Impulse: 125kV

AC withstand (1 Min): 54kV

P.D test at 30kV: <math><10\text{pC}</math>

Continuous current: 630A

### Application

For RMU switchgear apparatus

System voltage(Um) of 24kV

Continuous Current 630 A.

For indoor and outdoor installations.

Mounting in vertical or horizontal position.

### Standards

Meets the interface requirements of CENELEC HD506 S1, ANSI/IEEE 386, DIN 47636

Has been tested with mating parts to IEC 60502-4 and CENELEC HD 629.1 S1

### Quality Assurance

Our manufacturing facility is registered to ISO 9001-2000 by third party audit.

Required production test.

100% factory tested.

### Packaging

Supplied in a kit with all necessary parts.

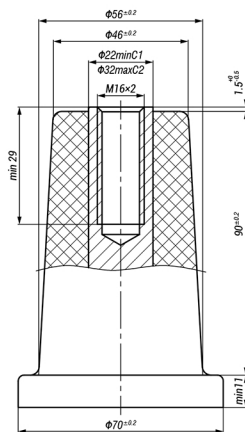

### Short Circuit Rastings

| Interface type | Contact type | Current rating (A) | RMS symm (kA) |        |        | Peak symm (kA) |
|----------------|--------------|--------------------|---------------|--------|--------|----------------|
|                |              |                    | 1 sec.        | 2 sec. | 3 sec. |                |
| C1             | Bolted       | 630                | 28.0          | 19.7   | 16.1   | 70             |
| C2             | Bolted       | 1250               | 75.0          | 53.0   | 43.3   | > 150          |